

# GDR Telecom Site Energy Systems

## 10G optical module Ic



## 10G optical module lc



Each single mode 10G SFP+ transceiver is equipped with a duplex LC fiber connection interface, and supports high-speed data rates up to 10.31Gbps. All ...



Explore the features, applications, and selection guide for optical transceiver SFP+ 10G single-mode 1310nm 10km LC modules for data centers and enterprise networks.



H!Fiber offers one-stop Datacenter solution and products, including SFP Transceivers, DAC Cables, Network Card, Media Converters, Fiber Optical Cables, Minisas Cables and more.



SFP+ transceiver that supports 10G connections up to 10 km using single-mode fiber with a duplex LC UPC connector.



Compatible with both 62.5um and 50um LC cables; Supports OM1/OM2/OM3/OM4 fiber cables. Protected by high-quality zinc metallic casing to ensure good heat dissipation and low ...



Each single mode 10G SFP+ transceiver is equipped with a duplex LC fiber connection interface, and supports high-speed data rates up to 10.31Gbps. All TRENDnet 10G SFP+ fiber modules support ...



The XG-SFP-LR-SM1310 is aligned to IEEE 10GBASE-LR optical specifications and supports a link length of up to 10 kilometers over a single-mode fiber (SMF) with an LC connector.



Amphenol SFP Optical Modules • SFP+ Optical Modules from Cables on Demand are Now Available in both Short Range (SR) Multimode and Long Range (LR) Single Mode Transceiver versions.



XFP (10GB Small Form-factor Pluggable) optical module: "X" is the abbreviation of Roman numerals 10, all XFP modules are 10G optical module. The XFP optical module supports LC fiber optic connectors ...



Upgrade networks with our optical transceiver sfp+ 10g single mode module 1310nm 10km lc. This LC transceiver delivers effortless 10km connectivity for data centers and servers.

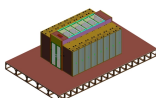

10GBASE-LR is a 10-gigabit Ethernet optical standard that operates at 1310 nm over single-mode fiber (SMF), supporting link distances of up to 10 km.

## Contact Us

For more information, pricing, or custom energy solutions, please contact us:

Website: <https://gdroofing.co.za>

Email: [sales@gdroofing.co.za](mailto:sales@gdroofing.co.za)

Phone: +27 72 418 9365

Address: 22 Electron Avenue, Isando, Johannesburg, 1600, South Africa

This document is for informational purposes only. Specifications subject to change without notice.

