

Connection method of 1-to-2 optical splitter



Connection method of 1-to-2 optical splitter



The optical splitter is usually connected to other optical devices or equipment through optical fiber. These connection interfaces will introduce insertion loss of the optical signal.



Learn about optical splitter split ratios (1:N, 2:N), centralized vs. cascaded architectures, and how to choose the right setup for FTTH PON networks.



Shown below is a simple 1X2 splitter with one input and two outputs. Basically, in one direction it splits the signal into 2 parts to couple to two fibers.



The central station and the optical splitter are connected by a backbone fiber cable (also called a feeder fiber cable), and the user terminal and the optical splitter are connected by a distribution fiber cable.



Understand the fundamentals and applications of optical splitter 1 in 2 out, a crucial component in fiber optic communication systems, CATV, and data centers. Explore design, ...



Optical coupler and splitter guide: split or combine fiber signals, choose the right device, and optimize your fiber network for reliable performance.

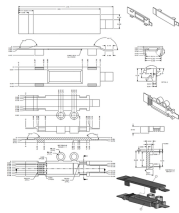

Directional 2 × 2 couplers (see Figure 1) are usually used for such purposes. The same kind of device is useful in fiber interferometers, also for combining two inputs.



In this guide, we'll explain how to safely connect a splitter to another splitter, covering both fiber optic and coaxial setups.



This article explores the technological foundation, real-world use cases, and product selection strategies for 1×2 fiber optic splitters, with a focus on Filter Type Fiber Splitter options ...



About this item ACTIVE OPTICAL SPLITTER 1 IN 2 OUT: BlueRigger fiber optical audio cable splitter allows you to connect one toslink audio source and split it into two receiving devices such as A/V ...



This article explores the technological foundation, real-world use cases, and product selection strategies for 1×2 fiber optic splitters, with a focus on ...



These various methods can be mixed in a network to best meet the performance and cost requirements for the network. The next document to be published on this topic will be a more comprehensive look ...

Contact Us

For more information, pricing, or custom energy solutions, please contact us:

Website: <https://gdroofing.co.za>

Email: sales@gdroofing.co.za

Phone: +27 72 418 9365

Address: 22 Electron Avenue, Isando, Johannesburg, 1600, South Africa

This document is for informational purposes only. Specifications subject to change without notice.

