

## Precautions for High Voltage Relay Protection

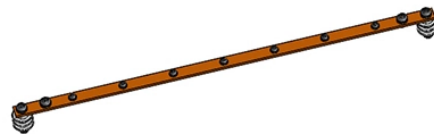

### Overview

Common safety measures include turning off power, using insulated tools, wearing protective gear, and following lockout/tagout procedures to ensure no one accidentally switches the power back on. Do not touch the terminal section (charged section) of the Relay or Socket while power is being supplied. Protective relaying is the backbone of fault detection and system isolation in As transmission systems grow increasingly complex with integration of. Cautions for Use-Check List Here is PDF of this page. A relay may be subjected to a variety of ambient conditions during actual use resulting in unexpected failure. Application considerations should be. Working with high-voltage equipment is dangerous and requires strict safety precautions to prevent electric shock, burns, or even death. In HV (High Voltage) and MV (Medium Voltage) substations, relay protection safeguards critical assets such as transformers, circuit breakers, and lines. Applications range from classic panel built control systems to modern interfaces between control microprocessors and their power circuits or any application where reliable galvanic separation is required between different circuits.

## Precautions for High Voltage Relay Protection



Relay protection is essential to ensure the stability, reliability, and safety of electrical power systems. In HV (High Voltage) and MV (Medium Voltage) substations, relay protection...



High voltage safety precautions and practices follow NFPA 70E and OSHA guidelines to reduce arc flash, shock, and electrocution risks through PPE use, proper procedures, and qualified worker training.



The investigation focused on the high-voltage transmission that ...



These guidelines for the safe management of high voltage electrical installations are issued under Section 33AA of the Electricity Act 1945 (WA) by the Director of Energy Safety and are endorsed by ...



By using a relay, relatively lightweight wiring can be used, saving space and increasing vehicle safety. A variety of circuits can be connected to an electrical relays.



Only trained and authorized personnel should handle high-voltage systems, and regular inspections, safety signs, and proper grounding should be in place. Following these precautions ...



Observe the following precautions to ensure safety. Do not touch the terminal section (charged section) of the Relay or Socket while power is being supplied. Electric shock may occur. Never use a Relay ...



The document outlines critical precautions for handling and modifying Reed Switches in sensor and relay applications to ensure reliable operation. It emphasizes the ...



It is recommended to employ a contact protection circuit to increase the service life of the relay, to suppress noise, and to prevent the generation of carbide and nitric acid which otherwise will be ...



Protective relaying is the backbone of fault detection and system isolation in high voltage (HV) power networks. As transmission systems grow increasingly complex with integration of ...



Use that exceeds the specification ranges such as the coil rating, contact rating and switching life should be absolutely avoided. Doing so may lead to abnormal heating, smoke, and fire. Never touch live ...

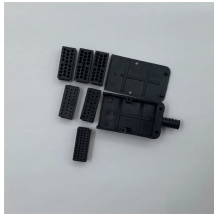

Introduction Relay systems protect high-voltage equipment and transmission lines to ensure safe, stable systems. Although failure of a protective relay system may have severe local or regional impacts, ...



This presentation discusses the basic principles of high voltage and includes high voltage work rules for both electric utility employees and others who may work near energized high voltage lines to include ...

## Contact Us

For more information, pricing, or custom energy solutions, please contact us:

Website: <https://gdroofing.co.za>

Email: [sales@gdroofing.co.za](mailto:sales@gdroofing.co.za)

Phone: +27 72 418 9365

Address: 22 Electron Avenue, Isando, Johannesburg, 1600, South Africa

This document is for informational purposes only. Specifications subject to change without notice.

