

What kind of cable is best for cable tray installation



What kind of cable is best for cable tray installation



This article explains the main requirements and good practices for cable tray systems, including tray types, materials, loading, supports, bonding, cable selection, and installation details.



Tray cable is durable and resistant to many environmental factors, but proper installation and practices are vital to ensuring safety and longevity. Conduit or cable raceways may be needed for additional ...



In all instances cables utilized within a cable tray system should be UL listed and marked as cable tray rated. The types of cables, allowed in cable trays, and the wiring methods permitted in cable trays ...



Tray cables are typically made with multi-conductor designs that are insulated and jacketed to provide protection from mechanical damage, chemicals, and other environmental ...



When used indoors, tray cables must adhere to the NM-B (Non-Metallic Sheathed Cable - B) standards, which are designed for general-purpose residential wiring. This ensures that the cables are protected ...



Whether you're an engineer, contractor, facilities manager or simply curious, this ultimate guide provides an in-depth understanding of tray cables, covering their types, standards, ...

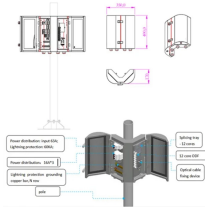

How do I choose the right type of tray cable for my installation? Choosing the correct type of tray cable depends on your specific application requirements, including the voltage rating, ...



What makes a tray-rated cable different from a standard multi-conductor? Tray cables are high-quality cables that have been tested rigorously and generally boast armor over individual conductors for ...



Tray cables follow a separate group of UL and NEC specifications and are more sturdy and resistant to heavy abrasion compared to other categories of cables. Read this guide to ...

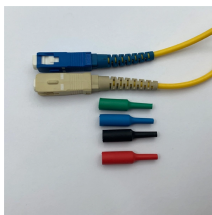

This guide covers the cable tray types and their appropriate applications, the fill rules for each configuration, ampacity derating requirements, separation of power and signal cables, and the ...

Contact Us

For more information, pricing, or custom energy solutions, please contact us:

Website: <https://gdroofing.co.za>

Email: sales@gdroofing.co.za

Phone: +27 72 418 9365

Address: 22 Electron Avenue, Isando, Johannesburg, 1600, South Africa

This document is for informational purposes only. Specifications subject to change without notice.

